

Badische Landesbibliothek Karlsruhe

Digitale Sammlung der Badischen Landesbibliothek Karlsruhe

**Geodaesia, Geometria, Technica, Chemica - Cod. Durlach
35**

Wagner, Theodor

[Solms], [1607]

Tractatus VIII. De optica delineatione omnium rerum, [...]

[urn:nbn:de:bsz:31-239855](https://nbn-resolving.org/urn:nbn:de:bsz:31-239855)

TRACTATUS. VIII.
 DE OPTICA DELINE
 ATIONE OMNI
 um rerum, ad
 bene viden
 dum pro
 posita
 rum

Per singulare quoddam &
 paucis cognitum infirmis.

SYNOPSIS.

Materia, quae
 e lignum sol-
 dum bene de-
 latum, & in
 quatuor angulis
 suis, imbutis
 bene minutim

Descriptio ejusdem
 quae conuenit
 partor, ut pote
 sunt.

Forma e obli-
 ga triangulari
 in latitudine
 habens pedem
 cum semise

Instrumēti ad
 hoc negotium
 pertinentis
 considerata
 veniunt

Quaedam appendi-
 ces faciunt in
 delineatione lineas
 Regule
 quae dupli-
 ces sunt

angular
 rector

Quaedam
 transversas
 casq. ad

Regule per
 perpendicularis
 Regularum
 Transversarum

oblique
 na
 rector
 eorū

oblique

usq. am e
 duplex na
 alius e rō
 Instrumēti

Applicatio
 nis effectus
 nā hinc rō
 solum

Res in Fundamento ob
 oculos positae.
 Res oblique respicit
 Res superius vel
 inferius oculus obliquus

Nunc agere incipiam brevibus quod maxime ad
 Attinet: ut quavis rem solidam et patet, hanc
 Attamen efficiam, rei similitudinem reporter
 usque adeo, ut pateant prima quae tibi.

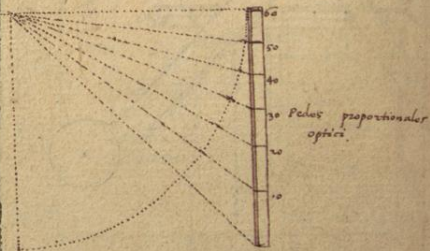

Orthographia scenographia Ichonographia
 sciographia. Simil.

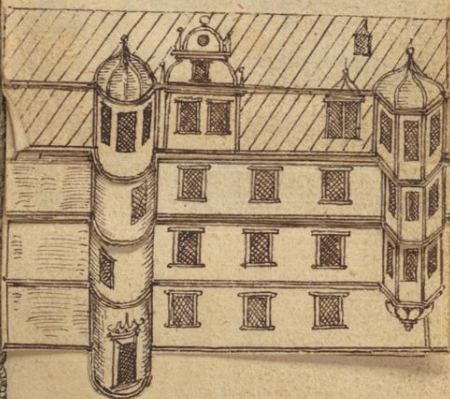

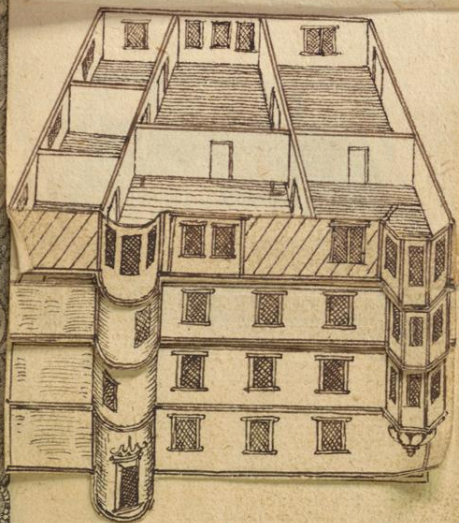

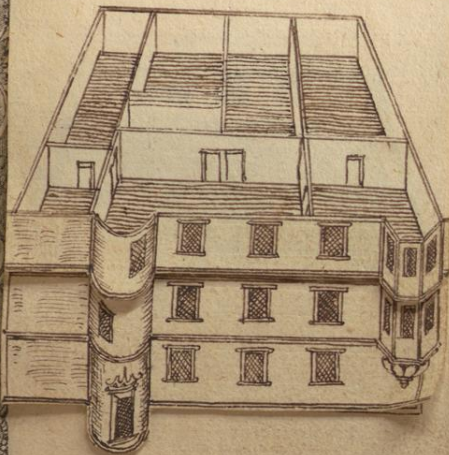

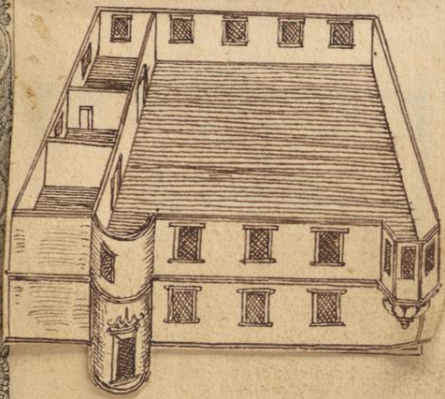

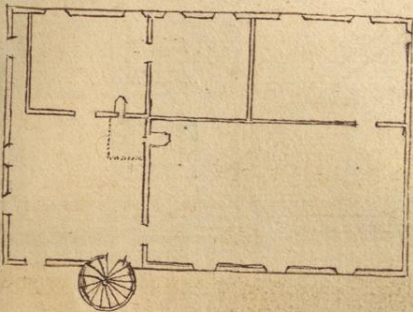

I

Si norma vel Regula transversa, in sinistro latere affixa, & inferiori data figura puncto aliquo applicata, intersect Regulam rectangulam perpendicularare: " Figura infra Horizontem data, punctum beneficio harum duarum regularam supra horizontem transportat, ita, ut ex area plani superficiali data figurae, fiat structura optica Solida.

Exemplum

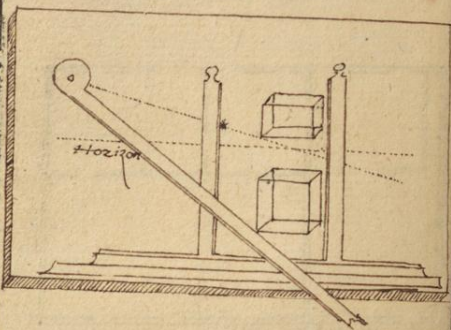

II
 Si regula Transversa in sinistro latere supra
 horizontem affixa, intersectat Regulam redangularem
 laterem perpendiculararem ad sinistram, Figura
 infra horizontem posita, & juxta prius præceptum
 punctum supra horizontem translata, apparebit
 ita, ut potentiam opticam transversam faciem
 exhibeat.

Exemplum.

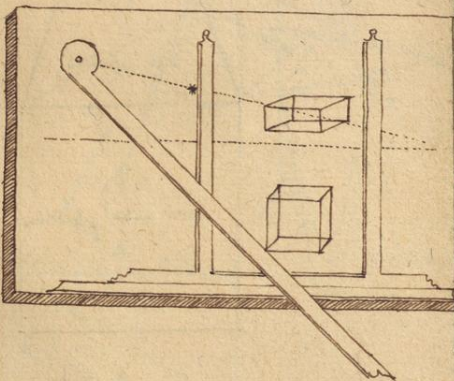

Quomodo planities superficialis R. in
arca quadrata A. transportatur in
optimum quadratum. L.

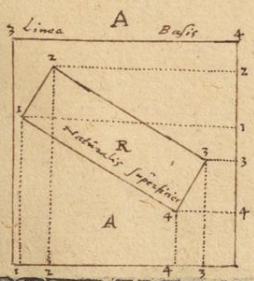
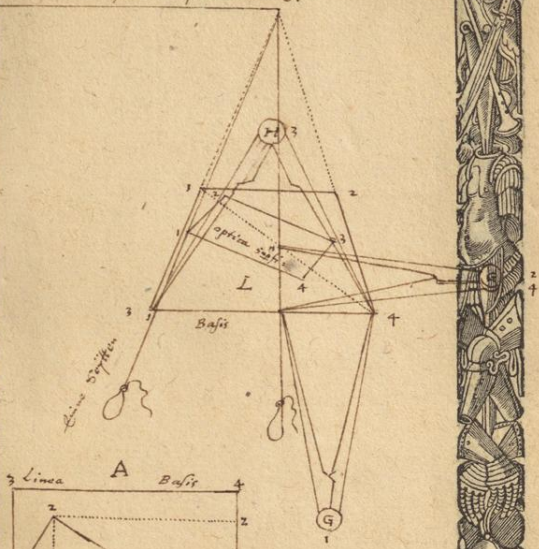

Explicatio priorum Schematum.

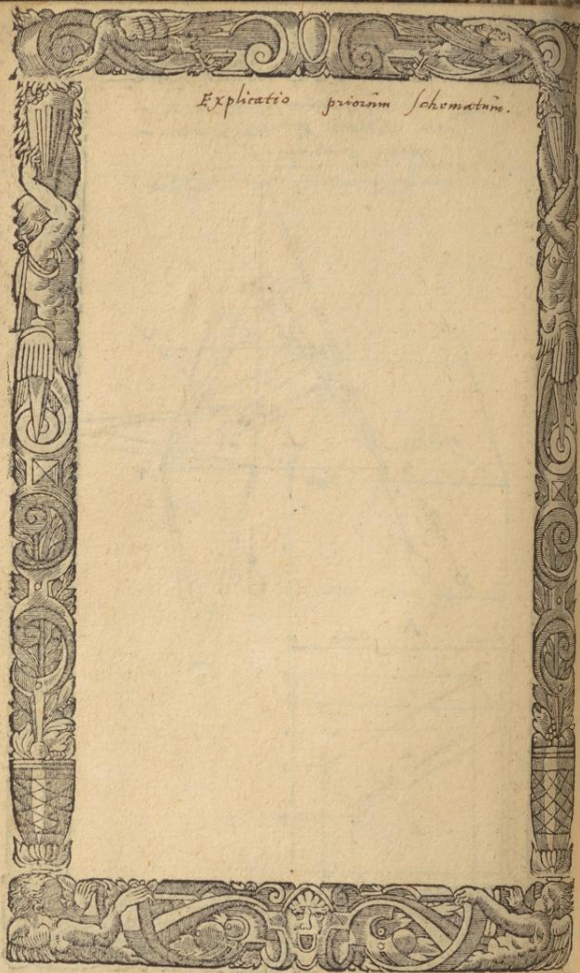

Ex data arā quacūq; Naturali
erigere . edificium vel
Strūcturam .

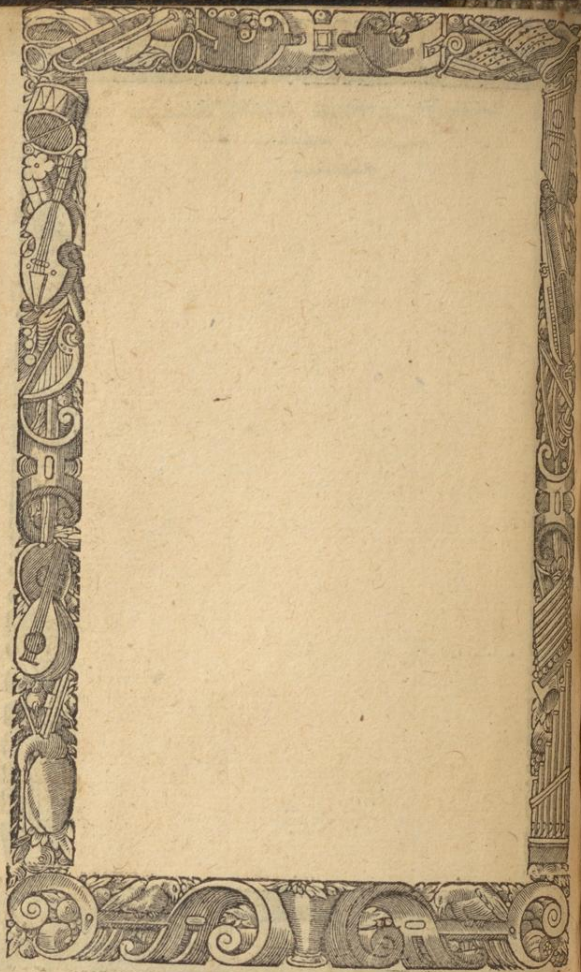

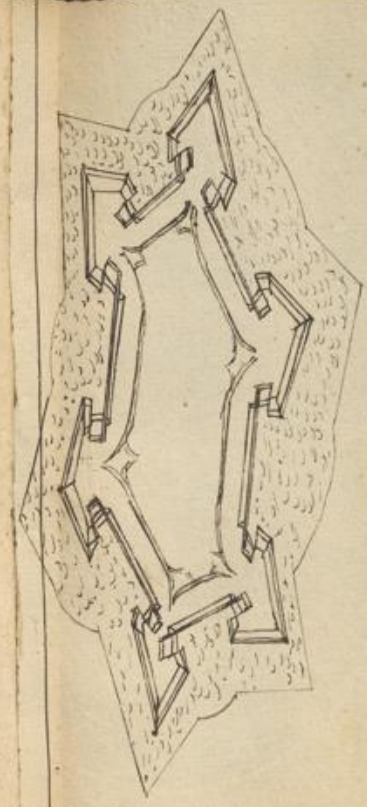

Die Wache Wohnung in d. Festung.
Gang & Thore mit Thürnen.

