

Badische Landesbibliothek Karlsruhe

Digitale Sammlung der Badischen Landesbibliothek Karlsruhe

Theorie und Bau der Wasserräder

Redtenbacher, Ferdinand

Mannheim, 1846

Illustrationen: Tafel I

[urn:nbn:de:bsz:31-273812](https://nbn-resolving.org/urn:nbn:de:bsz:31-273812)

K R O P F - R A D.

Fig. 2 Durchschnitt des Rades

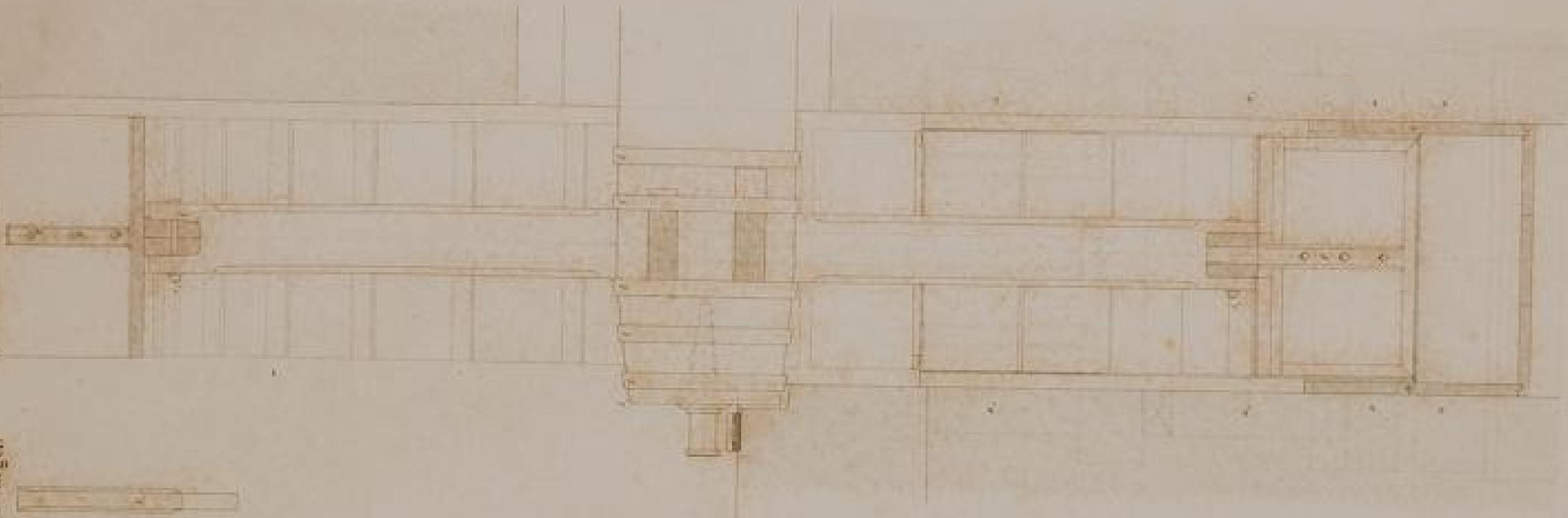

Fig. 3 Schaufelstirn (Kegel)

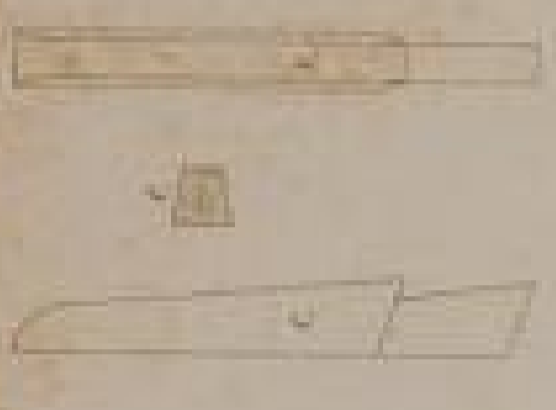
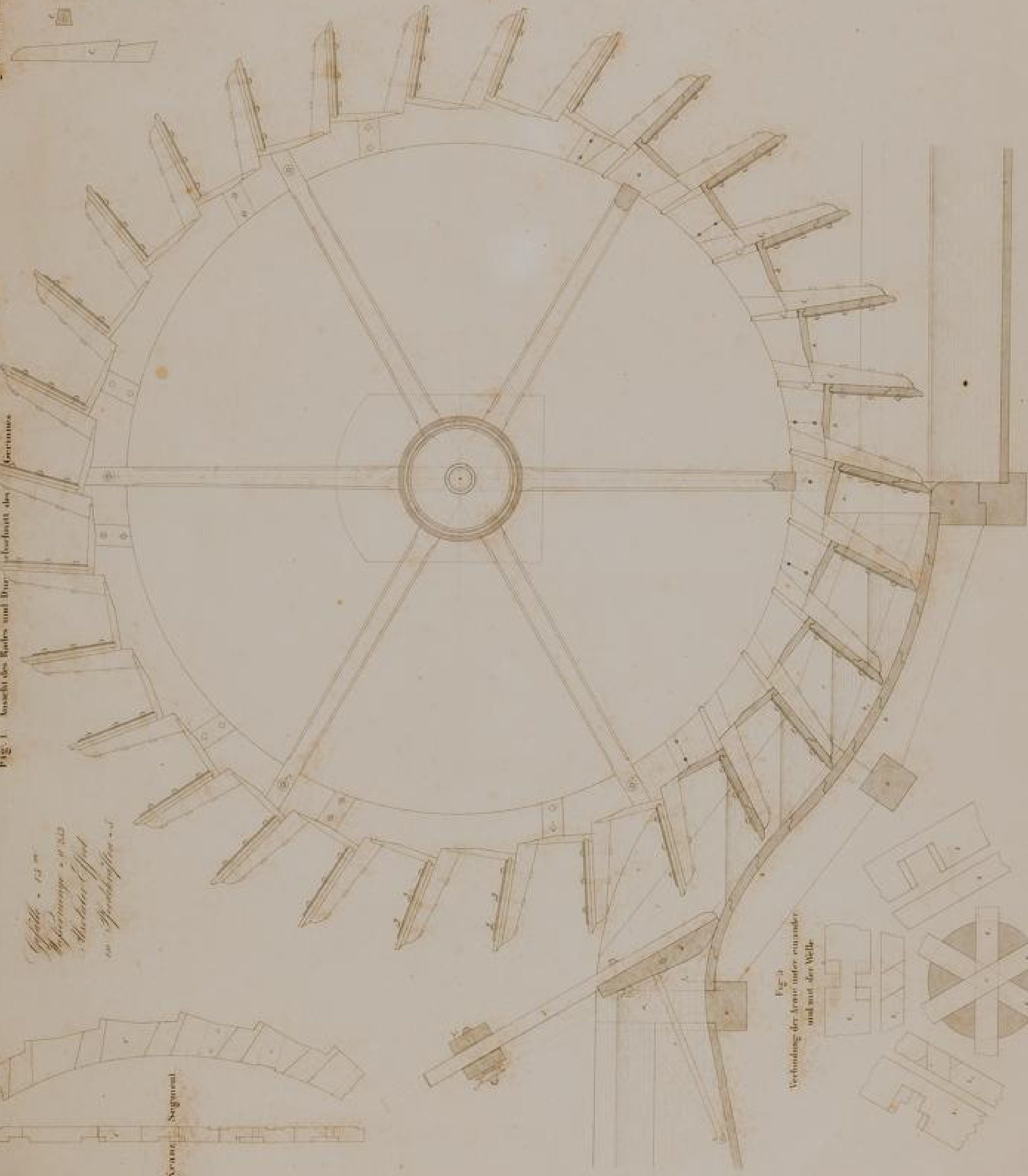

Fig. 1 Ansicht des Rades und der Verbindung des Rades mit der Achse



*Spindel . . . 12 m
Wasserrinne . . . 10 1/2
Abstände 1/2
im Spindelgange . . .*

Fig. 5 Krone-Segment



Fig. 4 Krone-Segmente



Fig. 6 Verbindung der Krone untereinander und mit der Achse

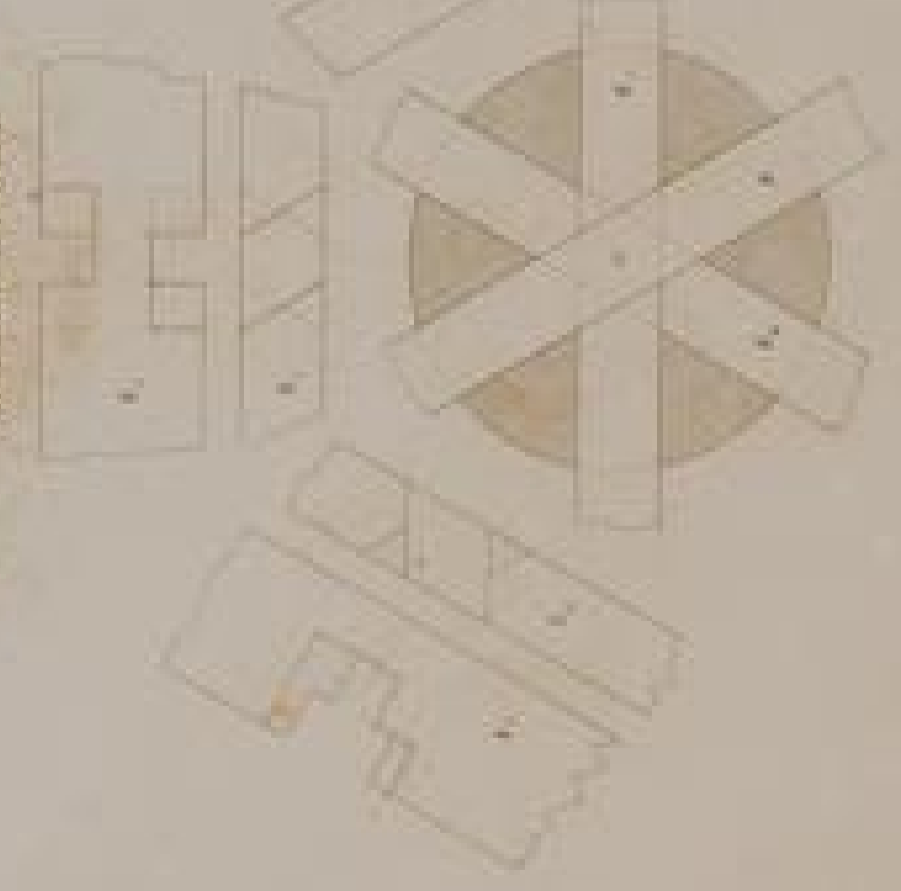

1 2 3 4 5 6 7 8 9 10 11 12 13 14 15 16 17 18 19 20 21 22 23 24 25 26 27 28 29 30 31 32 33 34 35 36 37 38 39 40 41 42 43 44 45 46 47 48 49 50 51 52 53 54 55 56 57 58 59 60 61 62 63 64 65 66 67 68 69 70 71 72 73 74 75 76 77 78 79 80 81 82 83 84 85 86 87 88 89 90 91 92 93 94 95 96 97 98 99 100

A

Faint, illegible text at the top of the page, possibly a title or header.

Faint, illegible text in the upper middle section of the page.

Faint, illegible text in the middle section of the page.

Faint, illegible text in the lower middle section of the page.

Faint, illegible text in the lower section of the page.

Faint, illegible text at the bottom of the page.

Vertical text on the right side of the page, possibly a date or reference number.

